

Included Hardware

- L-Brackets (2)
 - U-Bolts (2)
 - 1/2" Hex Nuts (4)
 - 1/2" Lock Washers (4)
-
- 5/16" Serrated Bolts (4)
 - 5/16" Serrated Nuts (4)
-
- 5/16" Bolts (4)
 - 5/16" Nuts (4)
 - 5/16" Washers (4)
 - 5/16" Fender Washers (4)
-
- Short, Straight Posts (2)
 - Canopy Support Arms (2)
 - Threaded Hand Knobs (2)
 - Canopy Shell (1)



← Point your phone's camera at this to watch the install video.

Watch our installation video found at www.tractorcanopy.com/faqs under the *Installation* section. Note the video shows the old hardware.

Mounting Instructions

Before you get started, place your machine on a level surface.

Step 1

After determining your Mounting Position (see other side), approximate 12" down from where you want the bottom of the shell to be. That's now the starting position of your L-Bracket. Using one U-Bolt and two lock washers and two nuts, hand-tighten your L-Bracket to the upright of your roll bar one either side. Repeat on the other side.

Step 2

Place a 5/16" serrated bolt through the top hole on the L-Bracket and the top hole on the 11" Post, securing in place with a serrated nut.

Insert another 5/16" serrated bolt through the slotted arc in the L-bracket and through the bottom hole in the 11" post, and place a serrated washer on the bolt.

Now slide a support arm over the straight post and secure it with the hand knob through the welded nut on back. Pivot the support arm so to the desired angle for your canopy shell and secure in place by tightening both serrated nuts.

Repeat the procedure on the other side matching the position of your first support arm.

Step 3

Position the shell on the support arms with the front (the end of the shell that has a logo on the bottom is the front), centering side-to-side. The forward-to-back position is up to you, but make sure you align the four holes in the support arms to the bottom of the flat ribs on the underside of the canopy. You'll be placing the fender washers on the topside above the holes, and they need enough clearance to seat against the shell and not run into a rib.

After double checking the shell alignment, mark one hole in the support arms onto the canopy shell, either with a drill bit or a marker. Drill through your canopy using a 3/8" bit. Insert a 5/16" bolt through a fender washer down from the top, into a washer and locking nut on the bottom. Snug in place. Now with the canopy held in place by the first bolt, repeat for the other three holes. Only snug the nuts, as the shell will expand and contract.

Step 4

Tighten all bracket bolts very tight. You are finished—enjoy the shade!

Backhoe Kit (optional purchase)

You might be able to sandwich the L-brackets together, one facing forward the second facing backwards using only one U-bolt for both L-Brackets.

Or you can mount the L-Brackets to the back side of the roll bar, mirrored behind the first set. Then follow the above instructions.

Note: Canopy support arms can't be wider than 33" apart.

← Front of Tractor

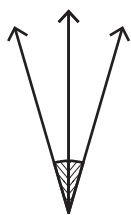

Position A: In Front of Roll Bar

If you are mounting your canopy in front of and below the top of your roll bar, and your roll bar doesn't lean more than 15°, mount your L-Brackets behind the roll bar, and facing forward.

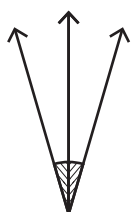
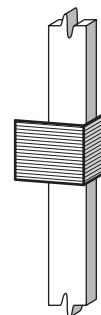

Position B: Above Roll Bar

If you plan to mount your canopy shell above your roll bar, mount the L-brackets so they face the rear of your tractor or mower, and high enough that the support arms can get up and over the top of your roll bar.

Note: Almost all zero turns mount above the roll bar.

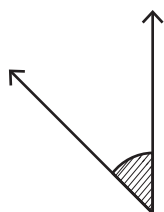
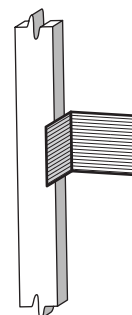

Position C: Angled Roll Bars

If your roll bar is angled 15° forward or more, mount your L-Bracket in front of your roll bar and facing forward.

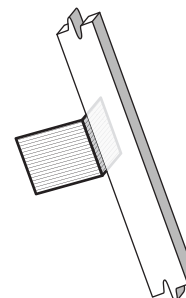

Lifetime Warranty

If anything goes wrong, we'll make it right. Just contact us.

269-873-5002

support@tractorcanopy.com

Safety Instructions

This unit, while having a great deal of static strength, is not intended as an overhead safety shield.

Remove your canopy when trailering your tractor or mower.